



0956 06



0957 18

Polyamide cable gland

Metric thread

- For non-armoured cables or armoured cables without earth continuity
- Polyamide body and locknuts (2 locknuts provided with each cable gland to cover the whole range)
- Neoprene sealing gaskets, supplied with weatherproof seal

Catalogue numbers

Metric thread	Cable seal		Weight (Kg)	Volume (dm ³)	Cat. No.	Pack
	Ø min	Ø max				
M16	3	8.5	0.1	0.9	0957 56	10
M20	6.5	14.5	0.2	0.9	0956 05	10
M25	8	18.5	0.2	0.9	0956 06	10
M32	10	25	0.2	0.9	0957 57	10
M40	24	34	0.4	1.2	0957 58	1
M50	28	42	0.5	1.2	0957 59	1

Electrical thread

- Polyamide body
- Polyamide locknuts
- Neoprene sealing gaskets, supplied with weatherproof seal

Electrical thread	Cable seal		Weight (Kg)	Volume (dm ³)	Cat. No.	Pack
	Ø min	Ø max				
PG 11	6.5	10.5	0.1	0.9	0956 00	10
PG 13	8	12.5	0.2	0.9	0956 01	10
PG 16	10	14	0.2	0.9	0956 02	10
PG 21	12.5	18.5	0.2	0.9	0956 03	10
PG 29	18	25	0.4	3.8	0956 04	10

Accessories

Nickel-plated brass nuts

Metric thread	Weight (Kg)	Volume (dm ³)	Cat. No.	Pack
M 16	0.04	0.08	0957 07	10
M 20	0.07	0.1	0957 01	10
M 25	0.1	0.2	0957 02	10
M 32	0.2	0.2	0957 03	10
M 40	0.2	0.2	0957 08	5
M 50	0.5	0.2	0957 09	5

Electrical thread	Weight (Kg)	Volume (dm ³)	Cat. No.	Pack
PG 11	0.03	0.08	0957 17	10
PG 13	0.04	0.08	0957 18	10
PG 16	0.1	0.08	0957 19	10
PG 21	0.1	0.4	0957 20	10
PG 29	0.2	0.4	0957 21	10

Part number in bold : fast moving references

Zones 21 and 22		ATEX	IEC	EC	II 2 G/D
EEx e II	IP68	IK08			

TECHNICAL DATA

Zones :

- 21 - 22

Classification :

- According to CENELEC
 - Conforming to ATEX Directive 94/9 EC and standards EN 50014-19
 - EC 0081 II 2 G for gas EEx e II
 - EC 0081 II 2 D for dust
- According to IEC
 - Conforming to standards IEC 60079-0/1 Ex e II
 - DIPA 21 for dust

Certification :

- Approved type EExE
- CENELEC LCIE 99 ATEX 6030 X
- IEC LCIE Ex 03
- declaration of conformity no. 50233

Protection index :

- IP68 according to IEC 60529 and EN 60529
- IK08 mechanical resistance according to EN 50102

Operating temperature :

- 20°C to +55°C

Dimensions (mm) :

- Cable gland

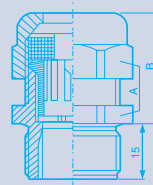

Cat. No.	A	B
0956 00	22	24
0956 01	24	26
0956 02	27	27
0956 03	33	32
0956 04	42	37
0956 05	27	30
0956 06	33	33
0957 56	19	24
0957 57	42	43
0957 58	55	47
0957 59	65	49

Locknut

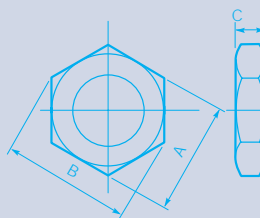

Cat. No.	A	B	C
0957 01	24	26.5	3.5
0957 02	33	36.5	3.5
0957 03	42	46.2	4.5
0957 07	19	21	3
0957 08	55	60	4.5
0957 09	65	70.1	5.5
0957 17	22	24.5	3.5
0957 18	24	26.5	3.5
0957 19	27	30	3.5
0957 20	32	35	4
0957 21	46	53	4