



1/2" Plug 0954 80

3/4" Adaptor  
0954 71

Bleed valve 0934 98

## Aluminium and zinc-plated steel plugs

### NPT tapered thread

Tapered thread (NPT)	Weight (Kg)	Volume (dm <sup>3</sup> )	Cat. No. Aluminium units, all volumes	Pack
1/2"	0.02	0.2	<b>0954 80</b>	10
3/4"	0.04	0.2	<b>0954 81</b>	10
1"	0.1	0.2	<b>0954 82</b>	1
Zinc-plated steel				
1" 1/4	0.2	0.4	<b>0954 83</b>	1
1" 1/2	0.2	0.4	<b>0954 84</b>	1

### Metric thread

Metric thread	Weight (Kg)	Volume (dm <sup>3</sup> )	Cat. No. Aluminium	Pack
M20 x 1.5	0.1	0.2	<b>0954 90</b>	1
M25 x 1.5	0.1	0.2	<b>0954 91</b>	1
M32 x 1.5	0.1	0.2	<b>0954 92</b>	1
Zinc-plated steel				
M40 x 1.5	0.2	0.3	<b>0954 93</b>	1
M50 x 1.5	0.2	0.3	<b>0954 89</b>	1

## Nickel-plated brass adaptors

### Metric/tapered

Metric male thread	Tapered female thread (NPT)	Weight (Kg)	Volume (dm <sup>3</sup> )	Nickel-plated brass all volumes	Pack
M20	1/2"	0.05	0.1	<b>0954 96</b>	5
M20	3/4"	0.1	0.1	<b>0954 97</b>	5
M25	3/4"	0.1	0.1	<b>0954 75</b>	5
M32	1"	0.2	0.2	<b>0954 98</b>	1
Tapered male thread (NPT)	Metric female thread	Weight (Kg)	Volume (dm <sup>3</sup> )	Nickel-plated brass all volumes	Pack
1/2"	M20	0.1	0.1	<b>0954 94</b>	1
3/4"	M20	0.1	0.1	<b>0954 71</b>	5
3/4"	M25	0.1	0.1	<b>0954 95</b>	1

### NPT tapered thread male/female reducers

Male thread (NPT)	Female thread (NPT)	Weight (Kg)	Volume (dm <sup>3</sup> )	Cat. No.	Pack
3/4"	1/2	0.1	0.1	<b>0954 50</b>	1
1"	3/4	0.1	0.1	<b>0954 51</b>	1
1" 1/4	3/4	0.3	0.2	<b>0954 52</b>	1
1" 1/4	1	0.3	0.2	<b>0954 53</b>	1
1" 1/2	1	0.3	0.2	<b>0954 54</b>	1
1" 1/2	1 1/4	0.3	0.2	<b>0954 55</b>	1

## Nickel-plated brass bleed valve

- Function: to drain condensation inside the boxes

Metric thread	Weight (Kg)	Volume (dm <sup>3</sup> )	Cat. No. all volumes	Pack
M20	1.1	0.9	<b>0934 98</b>	5

Metric thread reducers (see page 260)

Zone 1 & 2 - 21 & 22	ATEX	IEC	EC	II 2 G/D
EEx d IIC	IP 66			

### TECHNICAL DATA

Zones : 1 and 2 and 21 - 22

#### Classification :

- According to CENELEC
  - Conforming to ATEX Directive 94/9 EC and standards 50014-18
  - EC 0081 II 2 G for gas EEx d IIC
  - EC 0081 II 2 D for dust
- According to IEC
  - Conforming to standards IEC 60079-0/1 Exd IIC
  - DIPA 21 for dust

#### Certification :

- Approved type ACC
- CENELEC LCIE 03 ATEX0020U
- IEC LCIE Ex 03.022U
- **CE** declaration of conformity 5C217
- Conforming to standards EN 50281-1-1 and IEC 61241-1-1 "combustible dust"

Protection index : IP66 according to EN 60529 and IEC 60529

Operating temperature : - 40°C to + 55°C

#### Operating temperature :

CENELEC standards EN 50014/18 and to publications IEC I79.0/1

Threading and thread conforming to standards

NPT	NF E 03-601
Metric	ISO No. 965 I/III

#### Dimensions (mm) :

Adaptors/reducers

- Metric thread (see page 260)

- NPT tapered thread

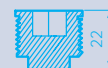

Cat. No.	A	B	C	D
0954 50	27	32	15	15
0954 51	35	35	18	22
0954 52	42	35	18	22
0954 53	42	35	23	22
0954 54	50	35	23	22
0954 55	50	47	22	22
0954 71	27	27	27	15
0954 75	32	35	18	13
0954 94	27	36	15	15
0954 95	32	38	15	15
0954 96	24	32	15	15
0954 97	30	32,5	15	15
0954 98	38	37,5	20	15

Bleed valve

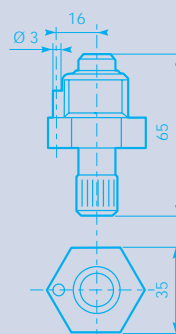

Plugs

