



Break glass call point

- Painted marine grade aluminium alloy box
- Grey painted body, red painted cover
- 2 x M25 threaded entries (cable gland not supplied)
- Upper entry blocked by a blanking plug
- Stainless steel chain
- Threaded flameproof joint
- Hammer can be immobilized by a lead tie
- Connection via 2.5 mm² terminals max
- 2 internal earths : 4 mm². External earth : M5 screw

Catalogue number

	Weight (Kg)	Volume (dm ³)	Cat. No.	Pack
Automatically activates as soon as glass is broken NO + NC contacts	1.2	3.8	0938 18	1

Limit switch

- Grey painted marine grade aluminium alloy box
- 1 x M20 or M25 threaded entry (cable gland not supplied)
- Threaded flameproof joint
- NO-NC contact 10 A – 230 V~
Travel 7 mm maximum. Force 22 Newtons
- Connection via 2.5 mm² terminals max
- Internal earth: 4 mm². External earth : M5 screw

Catalogue numbers

	Weight (Kg)	Volume (dm ³)	Cat. No. M20	Cat. No. M25	Pack
Stainless steel roller control perpendicular to fixing surface, 1/4 turn fixing (may be modified by the user) Force : 22 Newtons	1.1	6	0938 07	0938 05	1

Accessories

- **M25 integrated cable gland**

	Weight (Kg)	Volume (dm ³)	Cat. No.	Pack
For control stations Cat. Nos. 0938 80/85/90 sealed Ø: 9 mm minimum - 15 mm maximum grip Ø: 22 mm maximum Cone-shaped separator for flexible cable (Cat. No. 0954 60)	2.70	0.8	0934 96	5

For special options, please consult us:

- Stations with ammeter

Other cable glands (see pages 252/253/254/262 or 263)

Part number in bold : fast moving references

Zones 1 & 2 - 21 & 22	ATEX	IEC	EC	II 2 G/D
EEx d II C	T6	T = 80°C	IP66	IK10

TECHNICAL DATA

Zones :

- 1 and 2 and 21 - 22

Classification :

- According to CENELEC :
 - Conforming to ATEX Directive 94/9 EC and standards EN 50014-18
 - EC 0081 II 2 G for gas EEx d IIC T6
 - EC 0081 II 2 D - T = + 80°C for dust
- According to IEC :
 - Conforming to standards IEC 60079-0/1 Ex d IIC T6
 - DIPA 21 TA = + 80°C

Certification :

- Approved type BR1d
- CENELEC LCIE 02 ATEX 6056
- IEC LCIE Ex 02 005
- **CE** declaration of conformity No. 50230
- Conforming to standards EN 50281-1-1 and IEC 61241-1-1 (combustible dust)

Protection index :

- IP66 according to EN 60529 and IEC 60529
- IK10 mechanical resistance according to EN 50102

Operating temperature :

- 40°C to + 55°C

Anticorrosion treatment and climate protection : see page G50

Dimensions (mm) :

0938 18

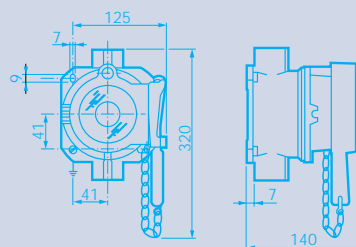

0938 05/07

