

increased safety



Control and indicators for mounting on enclosure door

* Actuators are supplied with seal, special nut and key

Push-buttons

	Weight (Kg)	Volume (dm ³)	Cat. No.	Pack
Push-button supplied with 4 red, green, yellow and white inserts	0.05	0.18	0983 00	1
Spring-return red mushroom head push-button	0.05	0.18	0985 01	1
Spring-return black mushroom head push-button	0.05	0.18	0983 01	1
Red "EMERGENCY STOP" key* switch mushroom head	0.05	0.18	0983 02	1
Red "EMERGENCY STOP" push-pull mushroom head	0.05	0.18	0983 03	1
Key* switch button, key removed in off and on button position	0.07	0.18	0983 20	1
Key* switch button key removed in on position	0.07	0.18	0983 21	1
Key switch button * 0 - 1 key removed in position 0	0.07	0.17	0983 22	1
Blanking plug	0.07	0.18	0983 38	5

Black selector switches

2 positions 0 - I latching	0.03	0.18	0983 24	1
3 positions I - 0 - II (steady)	0.03	0.18	0983 34	1
3 positions I - 0 - II (I and II automatic return)	0.03	0.18	0983 35	1
3 positions I - 0 - II with automatic return from II to 0	0.03	0.18	0983 36	1
3 positions I - 0 - II with automatic return from I to 0	0.03	0.18	0983 37	1

Contact components for door mounting

• Connection via 2 x 2.5 mm² terminals

	Weight (Kg)	Volume (dm ³)	Cat. No.	Pack
2 NO contacts	0.09	0.18	0981 10	1
2 NC contacts	0.09	0.18	0981 11	1
C/O contact	0.09	0.18	0981 12	1

• Contact components with sealed cable

Important: suitable for mounting on non Ex enclosure

• supplied with 3 m of cable 4 x 1,5 mm²

	Weight	Volume	Cat. No.	Pack
2 NO contacts	0.09	0.18	0981 20	1
2 NC contacts	0.09	0.18	0981 21	1
C/O contact	0.09	0.18	0981 22	1

Zone 1 & 2 - 21 & 22	ATEX	IEC	UL	II 2 G/D
EEx e II / EEx de IIC	IP 66			

TECHNICAL DATA

Zones : 1 and 2 and 21 - 22

Actuators, contact and signalling components

- Approved type : AUX
- According to CENELEC: 0081 II 2 G/D EEx e II (actuator)
EEx de IIC (contact)

LCIE: 00 ATEX 0002 U

- According to IEC : Ex e II (actuator) - EEx de IIC (contact)

LCIE: Ex 00.012 U

- According to UL : AEX e II

UL: E 214068

Operating temperature - 50°C to + 60°C (ATEX - IEC); - 35°C to + 60°C (UL)

Protection index IP66 (for actuators, indicator units and switch handles)

Contact components :

Reference insulation voltage :	690 V
Reference operating voltage :	250 V 250 V 110 V 24 V 230 V
Category of use	AC 12 AC 15 DC 13 DC 13
Rated operating current :	16 A 10 A 0.5 A 1 A 10 A
Rated current Ithe 16 A/+ 40°C, 11 A/+ 60°C	

Contact materials : Ag Sh 02

Number of operations : 10⁶ for contacts

Operational life : 10⁵ hours for indicators

Connection via terminals : 2.5 mm

Operating temperature : - 50°C to + 60°C

Dimensions (mm) :

0983 00

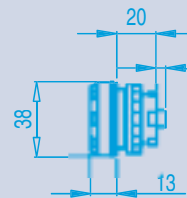

0985 01- 0983 01/02/03

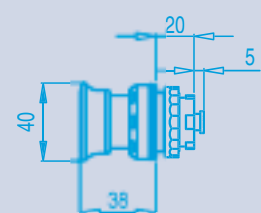

0983 20/21/22

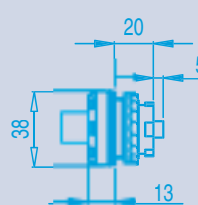

0983 38

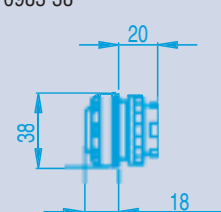

0983 23/24/30/31/32/33/34/35/36/37

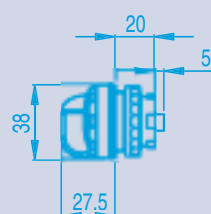

Data sheet available on request

Part number in bold : fast moving references