

# 316 L stainless steel complete and pre-drilled control stations

## increased safety

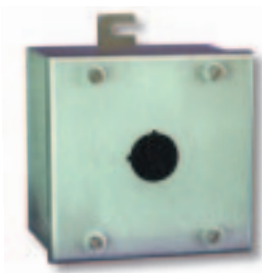

0989 75



0987 00



0987 03



Components:  
see pages 180 to 182

### 316 L stainless steel complete control stations

- 2 clearance entries for M20 at bottom for sizes 1 and 2
- 2 clearance entries for M25 at bottom for size 3
- External earth
- White self-adhesive dilophane identification label 58 x 18 mm
- Contact components fixed to the base of the box on **Din rail**
- Boxes delivered with 1 cable gland except 098972 (2 cable glands)

#### Size 1 (120 x 120 mm)

	Weight (Kg)	Volume (dm <sup>3</sup> )	Cat. No.	Pack
1 NC + NO push-button with red (O), green (I) inserts	1.2	2.4	<b>0989 70</b>	1
1 NC + NO red EMERGENCY STOP mushroom-head button, push-pull	1.2	2.4	<b>0989 71</b>	1
1 x 16 A double pole switch with 2 positions handle can be padlocked in position 0	1.2	2.4	<b>0989 72</b>	1
2 NC + NO push-buttons with red (O), green (I) inserts	1.3	2.4	<b>0989 73</b>	1



#### Size 2 (180 x 120 mm)

1 green indicator	1.8	3.3	<b>0989 74</b>	1
2 NC + NO push-buttons with red (O), green (I) inserts				
1 red indicator 2 NC + NO push-buttons with red (O), green (I) inserts	1.8	3.3	<b>0989 75</b>	1

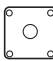

### 316 L stainless steel pre-drilled control stations

- Boxes delivered without cable glands

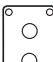

#### Size 1 (120 x 120 mm)

	Weight	Volume	Cat. No.	Pack
 Pre-drilled cover for 1 function (takes 1 x 4-pole switch 098821 to 32)	1	2.4	<b>0987 00</b>	1
 Pre-drilled cover for 2 functions	1	2.4	<b>0987 01</b>	1

#### Size 2 (180 x 120 mm)

 Pre-drilled cover for 2 functions (takes 1 x 4-pole switch 098821 to 32)	1.5	3.3	<b>0987 02</b>	1
 Pre-drilled cover for 3 functions	1.5	3.3	<b>0987 03</b>	1

#### Size 3 (180 x 180 mm)

 Pre-drilled cover for 4 functions (takes 2 x 4-pole switches 098821 to 32)	1.8	4.8	<b>0987 04</b>	1
 Pre-drilled cover for 6 functions	1.8	4.8	<b>0987 05</b>	

Part number in bold : fast moving references

Zones 1 & 2 - 21 & 22	ATEX	IEC	EC	II 2G/D
EEx ed IIC	T6	T = + 55°C	IP66	IK 10

### TECHNICAL DATA

Zones : 1 and 2 and 21 - 22

#### Classification:

- According to CENELEC:
  - Conforming to ATEX Directive - 94/9 EC - Standards EN 50014 - 18 - 19
  - EC 0081 II 2 G for gas EEx ed IIC T6
  - EC 0081 II 2 D - T = + 55°C for dust

#### According to IEC :

- Conforming to standards IEC 60079 - 0/1/7 Ex ed IIC T6
- DIPA 21 TA = + 55°C

#### Certification :

- Approved type JBe
- CENELEC LCIE 02 ATEX 6118X
- IEC LCIE Ex.02.010X
- declaration of conformity No. 50232
- Conforming to standards EN 50281-1-1 et IEC 61241-1-1 (combustible dust)

#### Protection index :

- IP66 according to EN 60529 and IEC 60529
- IK10 mechanical resistance according to EN 50102

#### Operating temperature :

- 40°C to + 70°C

Anticorrosion and climate protection : see page G50

#### Dimensions (mm) :

##### Size 1 box

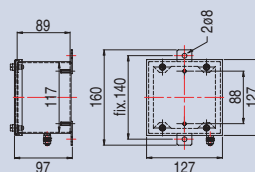

##### Size 2 box

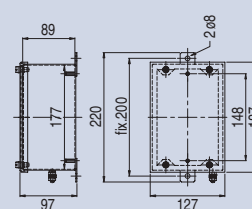

##### Size 3 box

